

oakheart

£250,000

64 Broomfield Road, Chelmsford



Welcome to this beautifully presented two-bedroom apartment, offering a perfect blend of modern living and convenience. Situated in a sought-after residential development, this property is ideal for first-time buyers, young professionals, or savvy investors.

Step into a bright and airy living space, enhanced by large windows that flood the room with natural light. The neutral palette and contemporary finish create a welcoming and versatile environment, perfect for relaxing or entertaining.

The sleek, modern kitchen is fitted with integrated appliances and

offers ample cupboard and countertop space, designed for both style and function.

Both bedrooms are well-proportioned, with the principal bedroom featuring large windows that provide a light and tranquil setting. The second bedroom offers flexible space, ideal as a guest room, home office, or nursery.

The modern bathroom features crisp tiling, a bath with shower over head and quality fixtures – all maintained to a high standard and designed with a clean, aesthetic.

Additional features include a secure communal entrance, efficient heating, and double glazing throughout.

Located close to local amenities, public transport links, and green spaces, this apartment is a perfect blend of urban convenience and comfortable living.











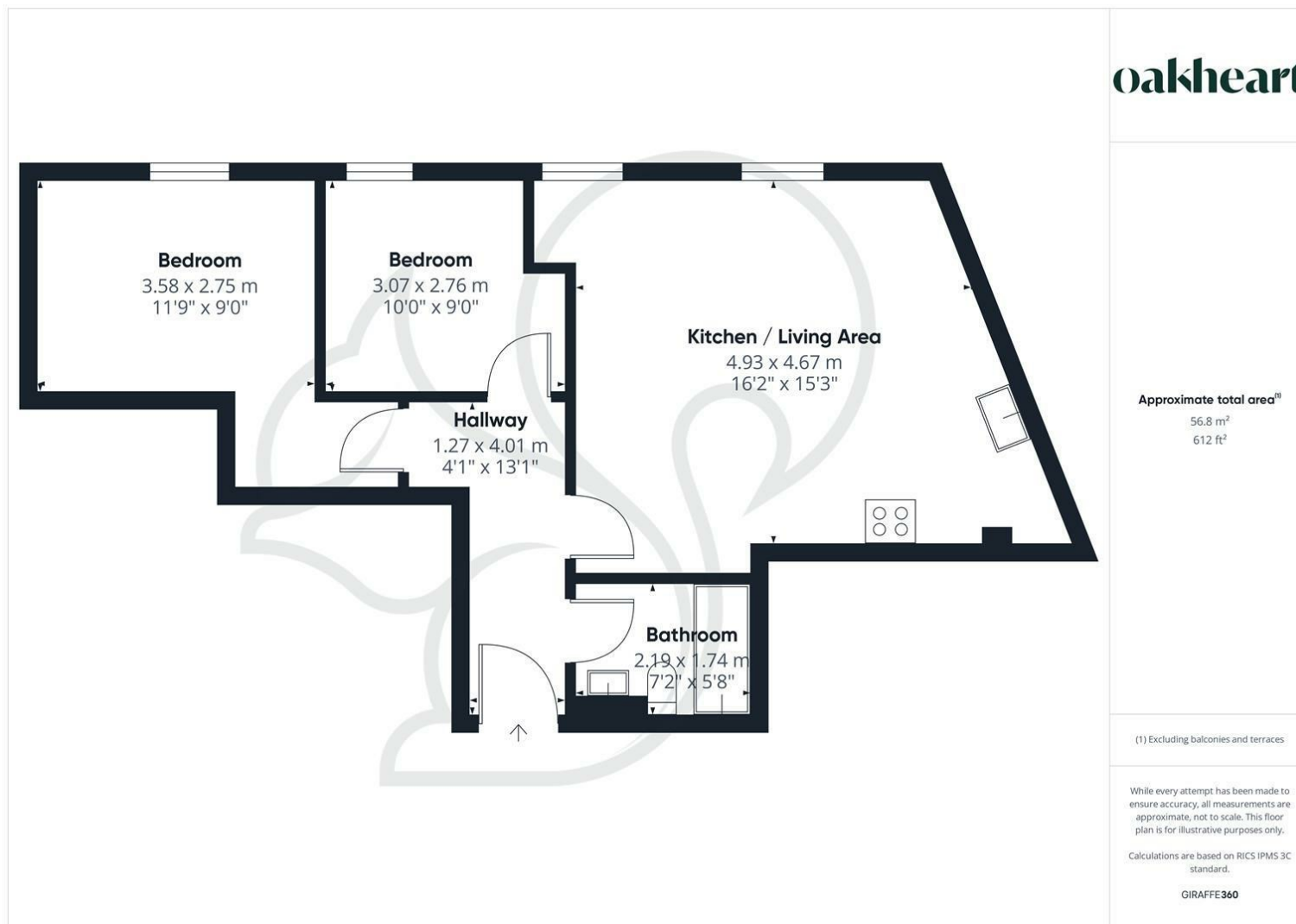



**oakheart**

**Local Authority:**  
Chelmsford City Council

**Tenure:**  
Leasehold

**Council Tax Band:**  
D

### Energy Efficiency Rating

	Current	Potential
Very energy efficient - lower running costs		
(92 plus) <b>A</b>		
(81-91) <b>B</b>	80	80
(69-80) <b>C</b>		
(55-68) <b>D</b>		
(39-54) <b>E</b>		
(21-38) <b>F</b>		
(1-20) <b>G</b>		
Not energy efficient - higher running costs		
<b>England &amp; Wales</b>		
	EU Directive 2002/91/EC 	

Agents Note: Whilst every care has been taken to prepare these particulars, they are for guidance purposes only. All measurements are approximate and are for general guidance purposes only and whilst every care has been taken to ensure their accuracy, they should not be relied upon.

Oakheart Chelmsford  
01245 800181  
chelmsford@oakheart.co.uk  
20 Victoria Road, Chelmsford, Essex, CM1 1PA

**oakheart**